

## 2. MECHANICS

### 2.1 Overview of Printing Mechanism

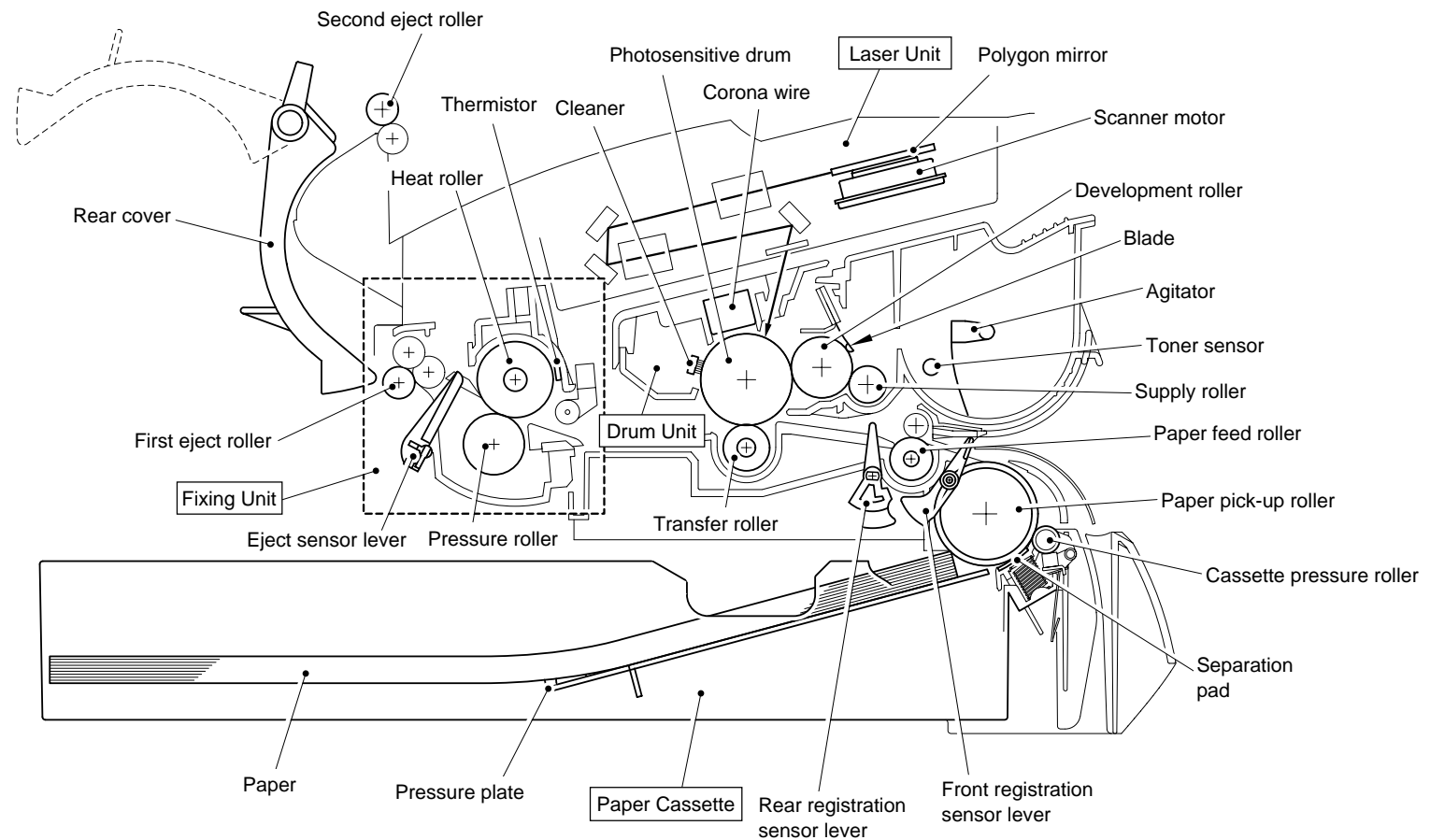

Fig. 3-27

### 3.16 Panel PCB ASSY

**NOTE:**

*Be sure to remove the drive unit and disconnect the panel PCB connector on the engine PCB before removing the panel PCB ASSY.*

- (1) Remove the M3x6 Taptite screw, then remove the panel PCB ASSY.

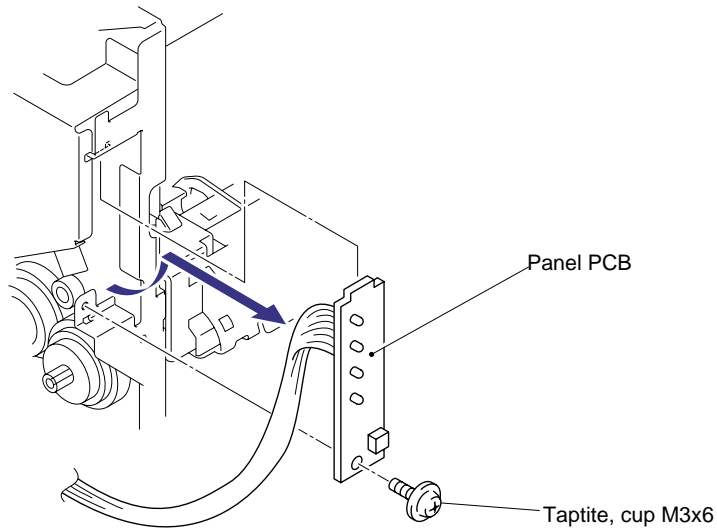

Fig. 4-57

### 3.17 Solenoid ASSY

**NOTE:**

*Be sure to remove the drive unit and disconnect the solenoid connector on the engine PCB before removing the solenoid ASSY.*

- (1) Place the main frame so that the drive unit side is at the top.
- (2) Release the catch and remove the planetary gear from the paper pick-up roller shaft.
- (3) Remove the planetary gear from the paper feed roller shaft and gear 56.

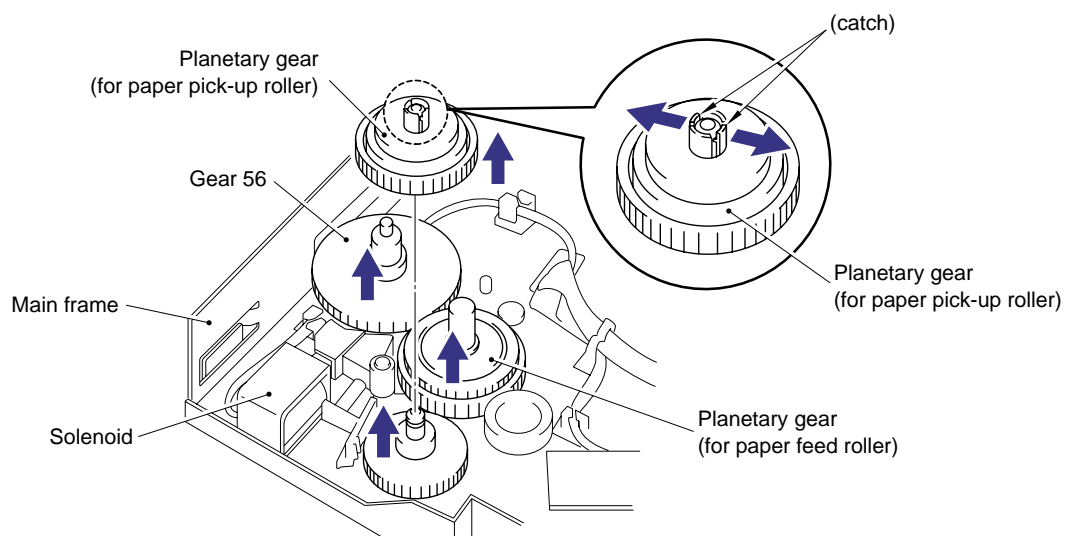

Fig. 4-58

- (4) Release the catch and remove the clutch levers for the feed roller and pick-up roller.

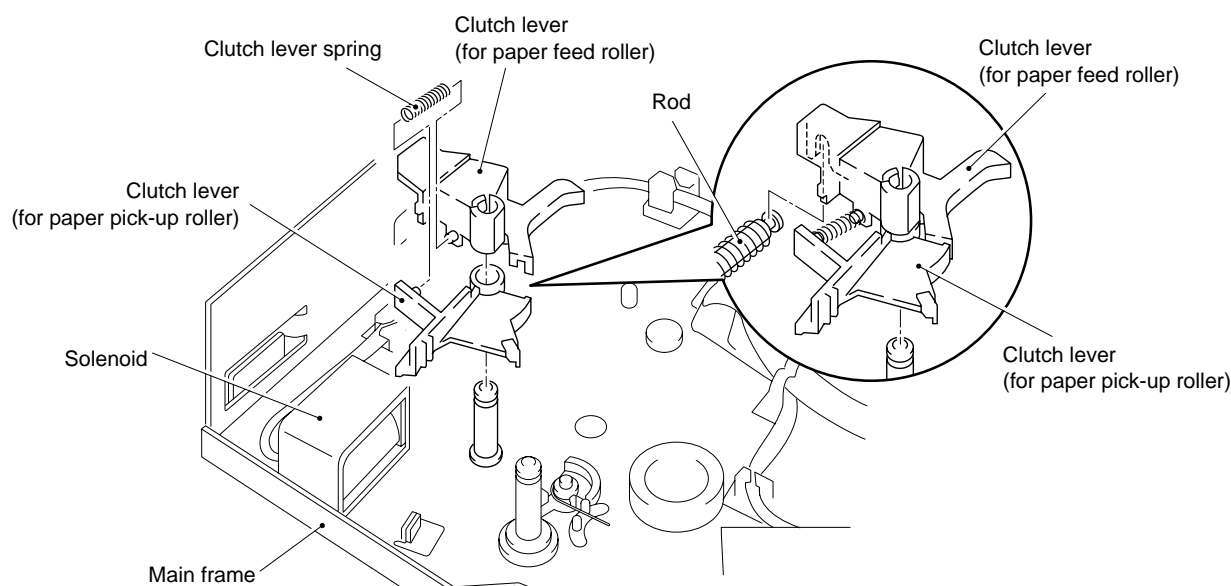

Fig. 4-59

**CAUTION:**

- When removing the clutch levers, the clutch lever spring may come off. Be sure not to lose it.
- When re-assembling the clutch lever for the paper feed roller, ensure that the U shaped groove of the lever is fitted onto the rod in the solenoid correctly referring to the figure above.

- (5) Place the main frame the right way up and remove gear 59 if not removed earlier during fixing unit removal.

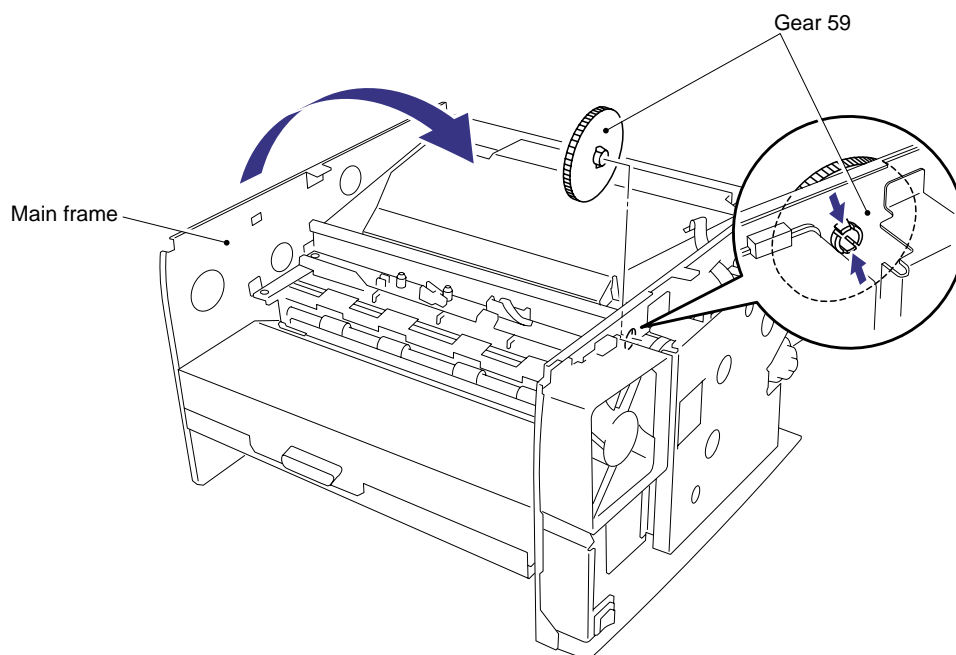

Fig. 4-60

**NOTE:**

When re-assembling the solenoid, ensure you do not forget to refit gear 59.